

Ball Transfer Unit Sheet Steel with big ball of plastic

size 15, 22, 30

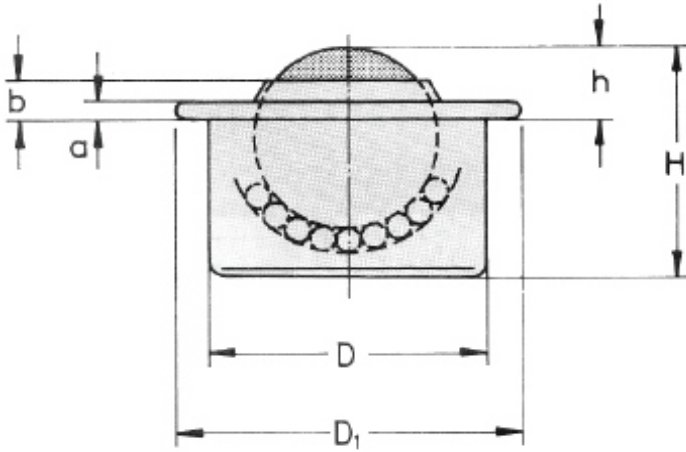

execution:	B - D	C - D	technical data							
big ball:	plastic	plastic	D	D1	h	H	a	b	weight	load-capacity
small ball:	hardened steel	stainless steel	$\pm 0,08$		$\pm 0,3$					
housing:	zincd steel	stainless steel	mm	mm	mm	mm	mm	mm	g	kg
ball \varnothing :	catalogue no.	catalogue no.	mm	mm	mm	mm	mm	mm		
15 mm	00.156.00	00.157.00	24	31	9,5	20,7	2,8	4,8	27	13
22 mm	00.226.00	00.227.00	36	45	9,8	29,5	2,8	5,5	89	22
30 mm	00.306.00	00.307.00	45	55	13,8	37,5	4,0	8,3	168	25

subject to changes

Ball Transfer Unit Sheet Steel with big ball of plastic are particularly well-suited to transporting goods with a sensitive surface, such as glass, polished aluminum, brass, and steel plate. These units have proven themselves in the food industry and in other areas. When compared to Ball Transfer Units with a steel or stainless steel ball, these have lower load capacity. Ball Transfer Unit Sheet Steel with big ball of plastic can easily be fitted into a larger tolerance bore on the functional side. In most cases, they do not require additional securing given the conical shape of the built-in casing.

The number and location of Ball Transfer Units depends on the weight to be conveyed as well as the size and the properties of the base area of the load. In order to ensure that the base area of the load fully rests on Ball Transfer Units and it does not slip into the gaps between the ball casters, the shortest edge length of the goods to be conveyed is divided by 2.5. The load divided by 3 gives the necessary load capacity per Ball Transfer Unit. An adequate security load should be added.