

Ball Transfer Unit Massive steel miniature light load

Size 8 and 12

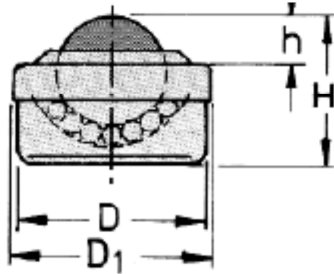

execution:	A	B	C	technical data				weight	load-capacity	
				D	D1	h	H		steel	stainless st.
balls:	hardened steel	hardened steel	stainless steel	± 0,08		± 0,4				
housing:	bright metal st.	zincd steel	zincd steel							
ball- Ø:	catalogue no.	catalogue no.	catalogue no.	mm	mm	mm	mm	g	kg	kg
8 mm	03.080.00	03.081.00	03.082.00	18	18	2,0	12,0	18	15	10
12 mm	03.120.00	03.121.00	03.122.00	22	22,2	6,0	18,0	35	20	15

subject to changes

Mini Ball Transfer Units are frequently used as guiding rolls. Given that there is no support collar, the load is distributed across the case. These are inserted into the bore with supporting plate. If fitted facing the floor, these units do not generally require any other measures for securing them.

The number and location of the Ball Transfer Units depends on the weight to be conveyed as well as the size and the properties of the base area of the load. In order to ensure that the base area of the load fully rests on Ball Transfer Units and it does not slip into the gaps between the ball casters, the shortest edge length of the goods to be conveyed is divided by 2.5.