

Ball Transfer Unit Massive Steel all parts stainless steel

size 15

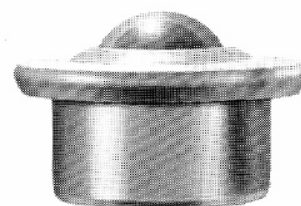

size 22, 30

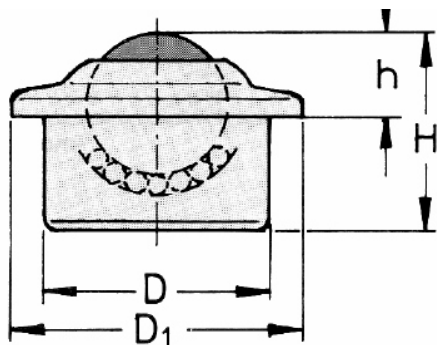
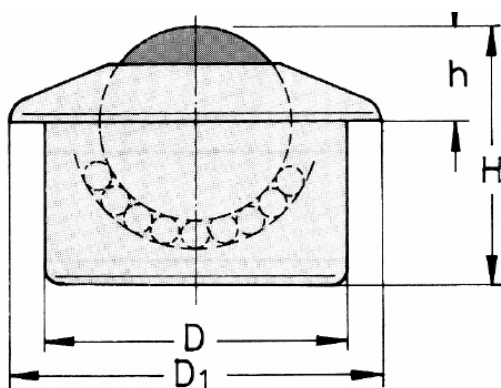

execution: all parts stainless steel

big ball: stainless steel

small balls: stainless steel 420

housing : stainless steel

ball- Ø: catalogue no.

technical data

D	D1	h	H	weight	load-capacity
	± 0,08	± 0,4			

ball- Ø:	catalogue no.	mm	mm	mm	mm	g	kg
15 mm	03.154.XX	24	31	9,5	21,0	45	28
22 mm	03.224.XX	36	45	9,8	30,5	115	90
30 mm	03.304.XX	45	55	13,8	36,8	300	145

Delivery time on request

subject to changes

Ball Transfer Units Massive Steel, all parts stainless steel are ideal for outdoor use. Housing and cover are made of non-corrosive materials. An impairment of the running properties is not to be feared in corrosive environmental conditions. Ball Transfer Units Stainless Steel can be used in practically all industrial branches, especially in food or beverage industry. From size 22 Ball Transfer Units Sheet Steel are equipped with a seal ring between the big ball and the housing. Ball Transfer Units without felt sealing resist temperatures about 400 ° C.

The number and location of Ball Transfer Units depends on the weight to be conveyed as well as the size and the properties of the base area of the load. In order to ensure that the base area of the load fully rests on Ball Transfer Units and it does not slip into the gaps between the ball casters, the shortest edge length of the goods to be conveyed is divided by 2.5. The load divided by 3 gives the necessary load capacity per Ball Transfer Unit. An adequate security load should be added.